

REVISED TO SHOW CONDITIONS AS OF:		
DATE	NAME	N.J. LIC. NO.
7/6/88	GEORGE C. LISSENDEN JR.	12946
7/20/88	GEORGE C. LISSENDEN JR.	12946
11/30/89	GEORGE C. LISSENDEN JR.	12946
12/31/90	GEORGE C. LISSENDEN JR.	12946
12/31/91	GEORGE C. LISSENDEN JR.	12946
12/31/92	GEORGE C. LISSENDEN JR.	12946
12/3/93	GEORGE C. LISSENDEN JR.	12946
12/3/94	GEORGE C. LISSENDEN JR.	12946
12/3/95	GEORGE C. LISSENDEN JR.	12946
12/31/96	GEORGE C. LISSENDEN JR.	12946
12/31/97	GEORGE C. LISSENDEN JR.	12946
12/31/98	GEORGE C. LISSENDEN JR.	12946
12/31/99	GEORGE C. LISSENDEN JR.	12946
12/3/00	JOHN A. ERNST, III, P.E. & L.S.	11759
12/31/01	JOHN A. ERNST, III, P.E. & L.S.	11759
12/31/02	JOHN A. ERNST, III, P.E. & L.S.	11759
12/31/03	JOHN A. ERNST, III, P.E. & L.S.	11759
12/31/04	JOHN A. ERNST, III, P.E. & L.S.	11759
12/31/05	CARL P. WERNER, P.L.S.	30094
12/31/06	CARL P. WERNER, P.L.S.	30094
12/31/07	CARL P. WERNER, P.L.S.	30094
12/31/08	CARL P. WERNER, P.L.S.	30094
12/31/09	CARL P. WERNER, P.L.S.	30094
12/31/10	CARL P. WERNER, P.L.S.	30094
12/31/11	CARL P. WERNER, P.L.S.	30094
12/31/12	CARL P. WERNER, P.L.S.	30094

TAX MAP OF

BOROUGH OF PINE BEACH

OCEAN COUNTY, NEW JERSEY

SCALES: AS INDICATED

JANUARY 1955

JOHN C. FELLOWS
ENGINEER
TOMS RIVER, N. J.

REVISED 15 MAY 1967 by
MARCUS H. RUSSELL, P.E. & L.S.
132 HOOVER AVE. TOMS RIVER, N.J.

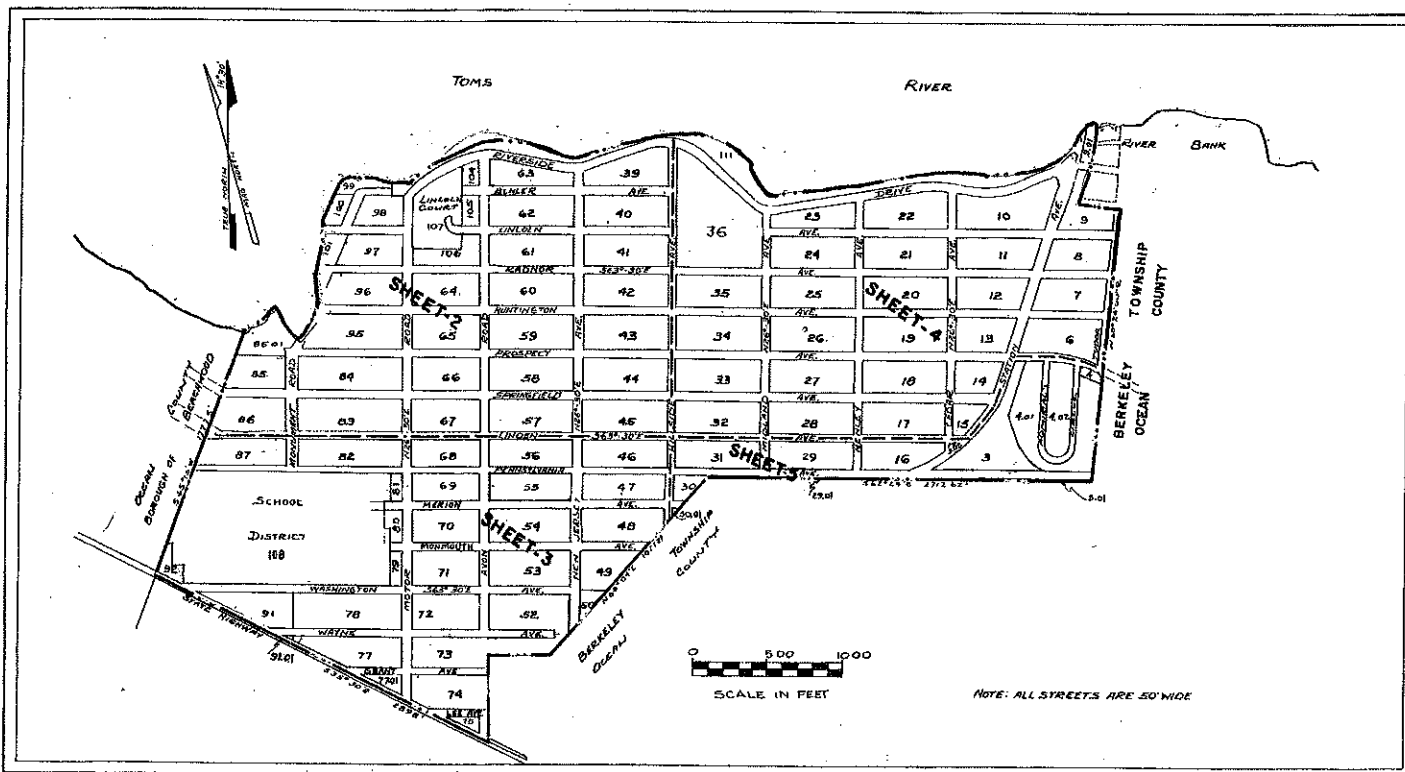

KEY MAP

INDEX OF SHEETS	
SHEET	DESCRIPTION
1	TITLE SHEET
2	NORTHWEST SECTION
3	SOUTHWEST SECTION
4	NORTHEAST SECTION
5	SOUTHEAST SECTION

TO SHOW REVISIONS AS OF JULY 6, 1988.
TO SHOW REVISIONS AS OF JULY 20, 1988.

DECEMBER 31, 1987: I HEREBY CERTIFY THAT THIS MAP HAS BEEN REVISED UNDER MY IMMEDIATE SUPERVISION AND COMPLIES WITH THE LAWS OF THE STATE OF NEW JERSEY.

George C. Lissenden Jr.
GEORGE C. LISSENDEN JR., P.E. & L.S. No. 12946

JULY 28, 1987: I HEREBY CERTIFY THAT THIS MAP HAS BEEN REVISED UNDER MY IMMEDIATE SUPERVISION AND COMPLIES WITH THE LAWS OF THE STATE OF NEW JERSEY.

George C. Lissenden Jr.
GEORGE C. LISSENDEN JR., P.E. & L.S. No. 12946

I HEREBY CERTIFY THAT THIS MAP HAS BEEN REVISED UNDER MY IMMEDIATE SUPERVISION AND COMPLIES WITH THE LAWS OF THE STATE OF NEW JERSEY.

George F. Keppler
GEORGE F. KEPPLER, L.S., No. 9102
5-84

REV. PER. DIVISION OF TAXATION LATER DATED 7/2/01	7/18/01	GRT		
ADDED 18th BOUNDARY & REVISED BUCKLE B. D.A.	JAN 27, 1970	CHAJ	MMR	MMR
DESCRIPTION OF REVISION	DATE	DRAWN	CHECKED	APPR'D.

NEW JERSEY DEPARTMENT OF THE TREASURY	
APPROVED AS A TAX MAP PURSUANT TO THE PROVISIONS OF CHAPTER 175 LAWS OF 1913	
BY <i>E. Bennett</i>	SUPERVISOR
DATE DEC 5 1955	SERIAL NO. 176

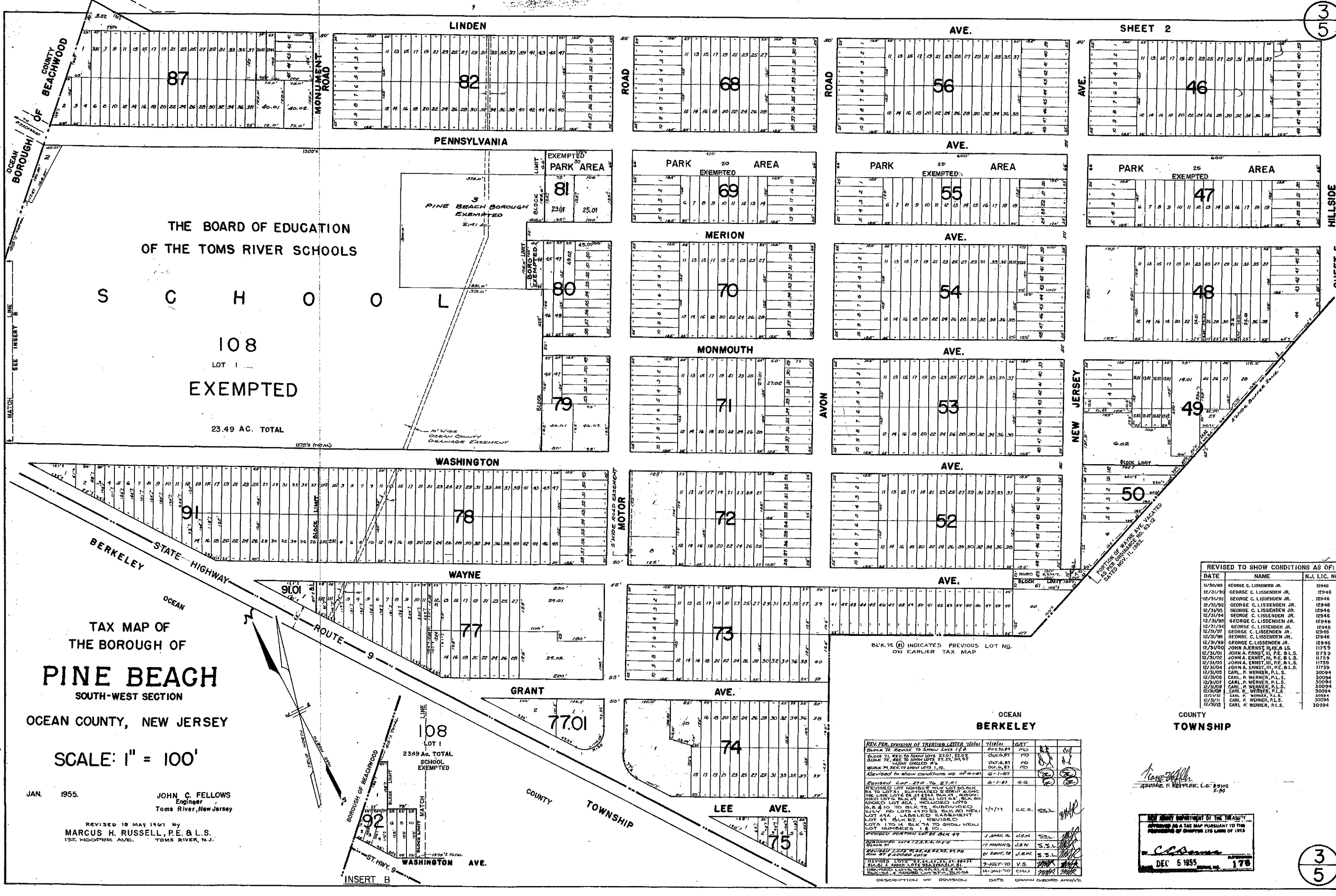

REVISED TO SHOW CONDITIONS AS OF:

DATE	NAME	N.J. LIC. NO.
11/30/89	GEORGE C. LISSENDEN JR.	12946
12/31/90	GEORGE C. LISSENDEN JR.	12946
12/31/91	GEORGE C. LISSENDEN JR.	12946
12/31/92	GEORGE C. LISSENDEN JR.	12946
12/31/93	GEORGE C. LISSENDEN JR.	12946
12/31/94	GEORGE C. LISSENDEN JR.	12946
12/31/95	GEORGE C. LISSENDEN JR.	12946
12/31/96	GEORGE C. LISSENDEN JR.	12946
12/31/97	GEORGE C. LISSENDEN JR.	12946
12/31/98	GEORGE C. LISSENDEN JR.	12946
12/31/99	GEORGE C. LISSENDEN JR.	12946
12/31/00	JOHN A. ERNST III, P.E. & L.S.	11759
12/31/01	JOHN A. ERNST III, P.E. & L.S.	11759
12/31/02	JOHN A. ERNST III, P.E. & L.S.	11759
12/31/03	JOHN A. ERNST III, P.E. & L.S.	11759
12/31/04	JOHN A. ERNST III, P.E. & L.S.	11759
12/31/05	CARL P. WERNER, P.L.S.	30094
12/31/06	CARL P. WERNER, P.L.S.	30094
12/31/07	CARL P. WERNER, P.L.S.	30094
12/31/08	CARL P. WERNER, P.L.S.	30094
12/31/09	CARL P. WERNER, P.L.S.	30094
12/31/10	CARL P. WERNER, P.L.S.	30094
12/31/11	CARL P. WERNER, P.L.S.	30094
12/31/12	CARL P. WERNER, P.L.S.	30094

BLK. 7E (E) INDICATES PREVIOUS LOT NO. ON EARLIER TAX MAP

REV. PER. DIVISION OF TAXATION LETTER #	DATE	APPROVED	DATE	APPROVED
BLK. 7E REVISED TO SHOW LOTS 27.01, 27.02	6-1-87	PD		
BLK. 7E REV. TO SHOW LOTS 27.21, 27.22	6-1-87	PD		
BLK. 7E REV. TO SHOW LOTS 1, 10	6-1-87	PD		
REVISED TO SHOW CONDITIONS AS OF	6-1-87	PD		
REVISED LOT 27.01 TO 27.01	6-1-87	PD		
REVISED LOT NUMBER NEW LOT 30 BLK 7E TO LOT 31 EXEMPTED 5.00 AC. ALONG ONE LINE LOT 28, 29, 30, 31, 32, 33, 34, 35, 36, 37, 38, 39, 40, 41, 42, 43, 44, 45, 46, 47, 48, 49, 50, 51, 52, 53, 54, 55, 56, 57, 58, 59, 60, 61, 62, 63, 64, 65, 66, 67, 68, 69, 70, 71, 72, 73, 74, 75, 76, 77, 78, 79, 80, 81, 82, 83, 84, 85, 86, 87, 88, 89, 90, 91, 92	7/1/77	C.E.S.		
BLK. 7E TO BLK. 7E SUBDIVIDED INTO 10 LOTS 41-50 BLK 7E NEW LOT 49A LABELED EASEMENT				
LOT 41 BLK 7E, REVISED LOTS 1 TO 14 BLK 7E TO SHOW NEW LOT NUMBERS 1 & 10				
REVISED PORTMAN LOT 44 BLK 44	1 APRIL 78	U.S.N.		
REVISED LOTS 7, 8, 9, 10, 11, 12	17 MARCH 78	U.S.N.		
REVISED LOTS 13, 14, 15, 16, 17, 18, 19, 20, 21, 22, 23, 24, 25, 26, 27, 28, 29, 30, 31, 32, 33, 34, 35, 36, 37, 38, 39, 40, 41, 42, 43, 44, 45, 46, 47, 48, 49, 50, 51, 52, 53, 54, 55, 56, 57, 58, 59, 60, 61, 62, 63, 64, 65, 66, 67, 68, 69, 70, 71, 72, 73, 74, 75, 76, 77, 78, 79, 80, 81, 82, 83, 84, 85, 86, 87, 88, 89, 90, 91, 92	21 SEPT. 78	U.S.N.		
REVISED LOTS 27.14, 27.15, 27.16, 27.17, 27.18, 27.19, 27.20, 27.21, 27.22, 27.23, 27.24, 27.25, 27.26, 27.27, 27.28, 27.29, 27.30, 27.31, 27.32, 27.33, 27.34, 27.35, 27.36, 27.37, 27.38, 27.39, 27.40, 27.41, 27.42, 27.43, 27.44, 27.45, 27.46, 27.47, 27.48, 27.49, 27.50, 27.51, 27.52, 27.53, 27.54, 27.55, 27.56, 27.57, 27.58, 27.59, 27.60, 27.61, 27.62, 27.63, 27.64, 27.65, 27.66, 27.67, 27.68, 27.69, 27.70, 27.71, 27.72, 27.73, 27.74, 27.75, 27.76, 27.77, 27.78, 27.79, 27.80, 27.81, 27.82, 27.83, 27.84, 27.85, 27.86, 27.87, 27.88, 27.89, 27.90, 27.91, 27.92	9-JULY-70	V.S.		
REVISED LOTS 27.14, 27.15, 27.16, 27.17, 27.18, 27.19, 27.20, 27.21, 27.22, 27.23, 27.24, 27.25, 27.26, 27.27, 27.28, 27.29, 27.30, 27.31, 27.32, 27.33, 27.34, 27.35, 27.36, 27.37, 27.38, 27.39, 27.40, 27.41, 27.42, 27.43, 27.44, 27.45, 27.46, 27.47, 27.48, 27.49, 27.50, 27.51, 27.52, 27.53, 27.54, 27.55, 27.56, 27.57, 27.58, 27.59, 27.60, 27.61, 27.62, 27.63, 27.64, 27.65, 27.66, 27.67, 27.68, 27.69, 27.70, 27.71, 27.72, 27.73, 27.74, 27.75, 27.76, 27.77, 27.78, 27.79, 27.80, 27.81, 27.82, 27.83, 27.84, 27.85, 27.86, 27.87, 27.88, 27.89, 27.90, 27.91, 27.92	14-JAN-70	CHLJ		

NEW JERSEY DEPARTMENT OF THE TREASURY
 APPROVED AS A TAX MAP PURSUANT TO THE
 PROVISIONS OF CHAPTER 176 LAWS OF 1915
 DEC 5 1955
 176

OCEAN COUNTY UTILITIES AUTHORITY EXEMPTED

SHEET 4

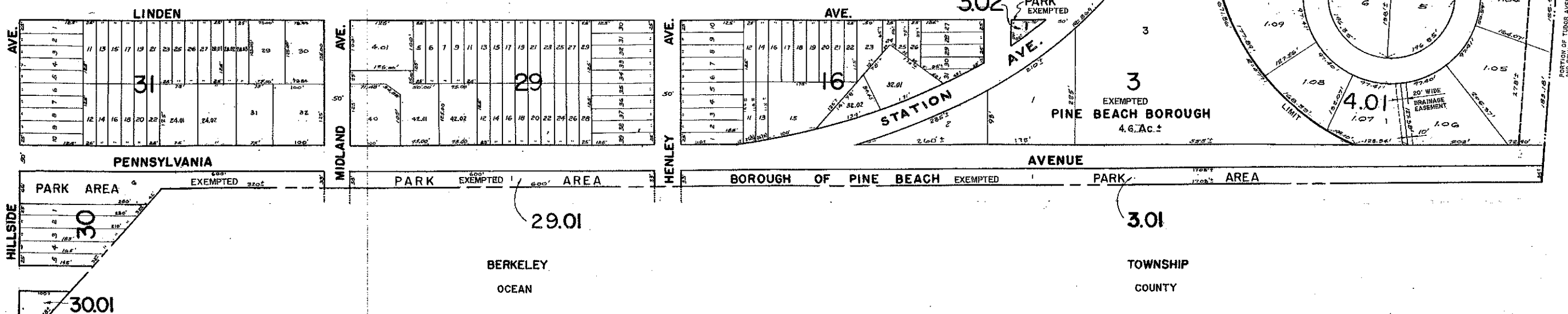

TAX MAP OF
THE BOROUGH OF
PINE BEACH
SOUTH-EAST SECTION
OCEAN COUNTY, NEW JERSEY

SCALE: 1" = 100'

1955
JOHN C. FELLOWS
Engineer
Toms River, N.J.

REVISED 15 MAY 1961 by
MARCUS H. RUSSELL, P.E. & L.S.
137 HOOPER AVE. TOMS RIVER, N.J.

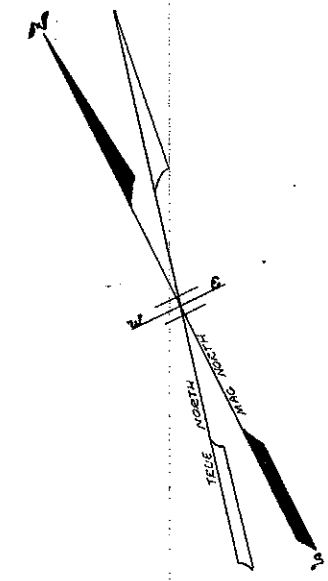

REVISED TO SHOW CONDITIONS AS OF:

DATE	NAME	N.J. L.I.C. NO.
11/30/89	GEORGE C. LISSENDEN JR.	12946
12/31/90	GEORGE C. LISSENDEN JR.	12946
12/31/91	GEORGE C. LISSENDEN JR.	12946
12/31/92	GEORGE C. LISSENDEN JR.	12946
12/31/93	GEORGE C. LISSENDEN JR.	12946
12/31/94	GEORGE C. LISSENDEN JR.	12946
12/31/95	GEORGE C. LISSENDEN JR.	12946
12/31/96	GEORGE C. LISSENDEN JR.	12946
12/31/97	GEORGE C. LISSENDEN JR.	12946
12/31/98	GEORGE C. LISSENDEN JR.	12946
12/31/99	GEORGE C. LISSENDEN JR.	12946
12/31/00	JOHN A. ERNST, III, R.E. & L.S.	11759
12/31/01	JOHN A. ERNST, III, R.E. & L.S.	11759
12/31/02	JOHN A. ERNST, III, R.E. & L.S.	11759
12/31/03	JOHN A. ERNST, III, R.E. & L.S.	11759
12/31/04	JOHN A. ERNST, III, R.E. & L.S.	11759
12/31/05	CARL P. WERNER, P.L.S.	30094
12/31/06	CARL P. WERNER, P.L.S.	30094
12/31/07	CARL P. WERNER, P.L.S.	30094
12/31/08	CARL P. WERNER, P.L.S.	30094
12/31/09	CARL P. WERNER, P.L.S.	30094
12/31/10	CARL P. WERNER, P.L.S.	30094
12/31/11	CARL P. WERNER, P.L.S.	30094
12/31/12	CARL P. WERNER, P.L.S.	30094

REVISION	DATE	BY	DESCRIPTION OF REVISION	DATE	BY	DESCRIPTION OF REVISION
REVISE LOT 28 BLOCK 31 TO CORRECTLY REFLECT THE HANCOCK SUBDIVISION MAP FILED 12/22/77 AS MAP 8-14-77B	12-22-77	MHR		7-18-10	GR	
CONSOLIDATED LOT 50 & LOT 24 LOT 24 & LOT 10 ADDED LOT NUMBERS TO PARK AREAS IN BLOCKS 2A 22A & 23	7-11-77	MHR		11-4-87	GR	
REVISED TO LOT 6, LOT 142 BER 29 TO BE 1 LOT BEA, BLC 23	12-22-75	MHR		4-15-80	GR	

George F. Keppeler, L.S. #3102
5-84

NEW JERSEY DEPARTMENT OF TREASURY
APPROVED AS A TAX MAP PURSUANT TO THE PROVISIONS OF CHAPTER 176 (REV. OF 1913)
DEC 5 1955
SERIAL NO. 178